

G50 Analogue Series

Outdoor PTZ Speed-dome Camera with Illumination



Features

- Sony FCB- "E" Series Modules
- 1/4 inch Ex-View CCD Colour Speed Dome Camera
- High Resolution up to 560 TVL
- High Precision PTZ device with original Sony FCB series modules
- Built-in Infrared, Visual or Laser Beamer

Dimensions (mm)

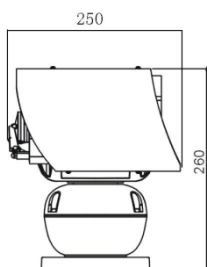
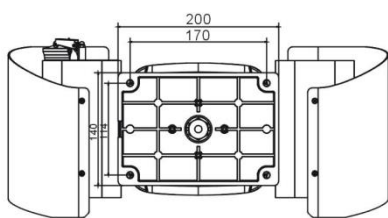
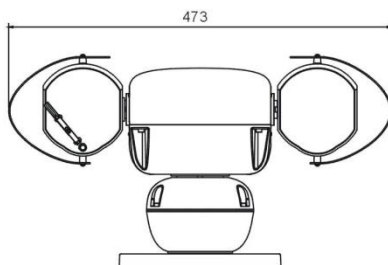

Technical Specifications

MODEL	G50
Camera Characteristics	
Optics	G50WB18EWD: Sony FCB 490EP, 18x Opt, f=4.1mm (wide) - 73.8mm(tele) 48.0° - 2.8°, Day:0.7Lux(1/50), 0.1Lux(1/3) Night:0.01Lux(1/3), Shutter Speed: 1 to 1/10,000 Sec G50WB28EWD: Sony FCB 995EP, 28x Opt f=3.5mm (wide) - 98.0(tele) 55.8° - 2.1°, Day:0.65Lux(1/50), 0.04Lux(1/3) Night:0.005Lux(1/3), with Image stabiliser, Shutter Speed: 1 to 1/10,000 Sec, Stable zoom upto 32x G50WB36EWD: Sony FCB 1020P, 36x Opt f=3.4mm(wide) - 122.4mm(tele) 57.8° - 1.7°, Day:1.4Lux(1/50), 0.1Lux(1/3) Night:0.01Lux(1/3), with Image stabiliser, Shutter Speed: 1/3 to 1/10,000 Sec, Stable zoom upto 40x * All models are equipped with 12x digital zoom * All models are equipped with 12x digital zoom
Signal Format	PAL/NTSC
Scanning	Interlace (IS) / Progressive Scan (PS)
Image Sensor	1/4 inch Ex-View HAD CCD
Resolution	550TVL, 560TVL (1020P)
Features	Auto/Manual Focus, Auto/Manual WDR, Auto/Manual White Balance (ATW, Indoor, Outdoor, Auto Sodium Vapour Lamp (fix/auto), One Push, Manual), Picture effect (E-Flip, Nega Art, BLC, Mirror Image, DNR, Colour Enhancement)
Iris control	Auto/Manual/Auto Slow Shutter
Privacy Masking	Max. upto 24 masks
Gain control	Auto/Manual(-3 to 28 dB,2 dB steps,16steps)
PTZ Characteristics	
PTZ Range	Pan: 360°, 0.4° to 320° per sec / Tilt: 90° (180° with Auto flip), 0.4° to 150° per sec
Preset position	128 positions
Sequence Tour	4 Preset tours
Scan Track	4 Scan tour
Pattern Track	4 Pattern Tour, 100 sec each
Idle protection	0 to 240 sec
Boot-up action	Preset, tours, tracks
Beamer Light	
Infrared Illuminator (IR)	Infrared LED Ø 8mm X 48pcs up to 200m
Visual Lamp (VL)	Osram Halogen, 24VAC, 30W up to 100m
Laser Infrared Illuminator (L)	IR Laser Beamer Class 3A with Optic adjustment up to 300m
Connection Interface	
Communication	RS-485, multiple-protocol, coax
Alarm inputs	7 inputs / 2 output
Operating Temperature range	-35°C ~ 65°C, Relative humidity 10-90%
Construction	Aluminium alloy, IP66 Rated
Dimension	S – Series: Ø198 (D) x 216 (H) mm, E (embedded) – Series: Ø245 (D) x 252 (H) mm
Power	12V DC / 24V AC
With Illumination	IR: max.55W, L: 60W, VL: 80W

Accessories

WP20-5 – Power

BW50 – Wall mount

BW7 – Pole mount

BW9 – Corner mount



Specifications may be subject to changes without notice