

High resolution PTZ Speed Dome Camera



Features

- Sony FCB- "E" Series Modules
- 1/4 inch Ex-View CCD Colour Speed Dome Camera
- High Resolution up to 560 TVL
- Interlace and Progressive Scan selectable
- Automatic Day/Night Mode
- Electric Image Stabilization
- Stablezoom*
- Low Power Consumption
- Colour Enhancement
- Intelligent Temperature Control
- IP66 Weather- and Lightning-proof
- Multi-protocol Communication through RS-485 Protocol
- Automatic Wide-Dynamic Image Enhancement (for clear images under difficult light condition)

Dimensions (mm)

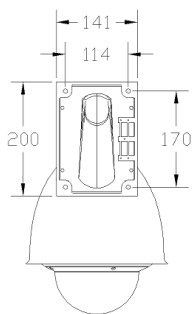
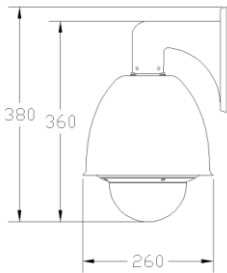

Technical Specifications

MODEL	G70
CAMERA CHARACTERISTICS	
Optics	<p>G70WB18EWD: Sony FCB 490EP, 18x Opt, f=4.1mm (wide) - 73.8mm(tele) 48.0° - 2.8° Day:0.7Lux(1/50), 0.1Lux(1/3) Night:0.01Lux(1/3) Shutter Speed: 1 to 1/10,000 Sec</p> <p>G70WB28EWD: Sony FCB 995EP, 28x Opt f=3.5mm (wide) - 98.0(tele) 55.8° - 2.1° Day:0.65Lux(1/50), 0.04Lux(1/3) Night:0.005Lux(1/3), with Image stabiliser Shutter Speed: 1 to 1/10,000 Sec, Stable zoom upto 32x</p> <p>G70WB36EWD: Sony FCB 1020P, 36x Opt f=3.4mm(wide) - 122.4mm(tele) 57.8° - 1.7° Day:1.4Lux(1/50), 0.1Lux(1/3) Night:0.01Lux(1/3), with Image stabiliser Shutter Speed: 1/3 to 1/10,000 Sec, Stable zoom upto 40x</p> <p>* All models are equipped with 12x digital zoom</p>
Signal Format	PAL/NTSC
Scanning	Interlace (IS) / Progressive Scan (PS)
Image Sensor	1/4 inch Ex-View HAD CCD
Resolution	550TVL, 560TVL (1020P)
Features	Autp/Manual Focus, Auto/Manual WDR, Auto/Manual White Balance (ATW, Indoor, Outdoor, Auto Sodium Vapour Lamp (fix/auto), One Push, Manual), Picture effect (E-Flip, Nega Art, BLC, Mirror Image, DNR, Colour Enhancement)
Iris control	Auto/Manual/Auto Slow Shutter
Privacy Masking	Max. upto 24 masks
Gain control	Auto/Manual(-3 to 28 dB, 2 dB steps, 16steps)
Slow Auto Exposure mode	up to 2 min
PTZ CHARACTERISTICS	
PTZ Range	Pan: 360°, 0.4° to 320° per sec / Tilt: 90°, 0.4° to 150° per sec with auto flip
Preset position	128 positions
Sequence Tour	4 Preset tours
Scan Track	4 Scan tour
Pattern Track	4 Pattern Tour, 100 sec each
Idle protection	0 to 240 sec
Boot-up action	Preset, tours, tracks
CONNECTION INTERFACE	
Communication	RS-485, multiple-protocol, coax
Alarm inputs	7 inputs / 2 output
Operating Temperature range	-40°C to 60°C
Weather Protection	IP66, Humidity 95%
Power	AC 24V / max. 24 VA

Accessories

WP20 – Power



BW1 – Ceiling mount



BW2 – Wall mount



BW7 – Pole mount



BW9 – Corner mount



Specifications may be subject to changes without notice